

Schematic drawing of safe

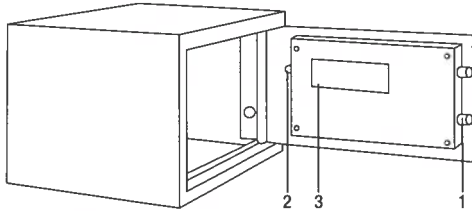

Schematic drawing of control panel

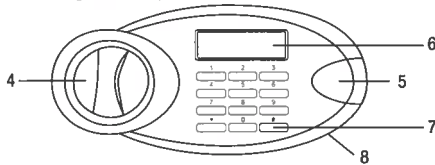

- |                        |                         |
|------------------------|-------------------------|
| 1. Bolts               | 5. Emergency Lock Cover |
| 2. Reset Button        | 6. Display              |
| 3. Battery Compartment | 7. Confirming button    |
| 4. Handle              | 8. External jack socket |

**OPENING YOUR SAFE FOR THE FIRST TIME**

You have 2 options to open the safe:

**OPTION A:**

- The safe has been supplied with an external battery holder, insert 4 x AA alkaline batteries (not supplied) into the holder, and plug this into the jack socket on the bottom of the keypad (8), (shown in the images below).
- Press "#" to activate the electronic lock.
- Enter the pre-set user code "1234", then press the "#" button, the display will show "OPEN"
- Turn the handle clockwise while the display is illuminated and pull the door open.

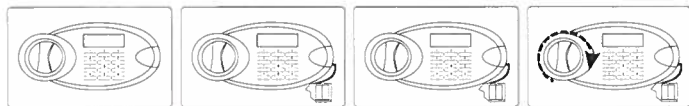

**OPTION B:**

- Remove the emergency lock cover (5) and use emergency key.
- Insert the emergency key, turn anti-clockwise and turn the handle clockwise to open the door.

**CAUTION:** Once the door has been opened remove the key and keep it in a safe place. (DO NOT STORE THE EMERGENCY KEYS INSIDE THE SAFE).

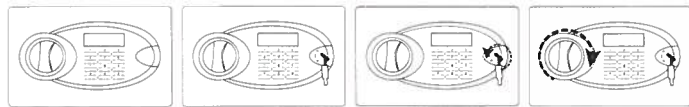

**INSERTING THE BATTERIES**

- With the door open, insert 4 x AA alkaline batteries (not supplied) into the battery compartment (3). When the batteries are inserted, the display will show a series of "0" then flash "GOOD". The display will then be in standby mode, showing the year, month, date and day.

**CAUTION:** If the display shows "LO-BATIE", it means the voltage is low and you should insert new batteries. Replace the batteries immediately, lining them up as indicated by the "+" and "-" signs.

**OPENING THE DOOR**

- Press the "#" button to activate the display.
- Input the user code and press "#" to confirm. (The pre-set code is 1234).
- Turn the handle clockwise to open the door.

**NOTE:** If an incorrect digit is inputted, you can clear this by pressing the "\*" button. One digit will be cleared each time the "\*" button is pressed.

**CAUTION:** If the wrong code is entered 3 times consecutively, the key pad will automatically lock and the alarm will sound for 60 seconds. While the alarm is sounding if the correct code is entered the alarm will stop.

**HIDDEN CODE FUNCTION**

- Before entering the code to open the safe, press the "#" followed by the "\*" button. The numbers will not be shown on the display when inputting code.

**CLOSING THE DOOR**

- Close the door and turn the handle anti-clockwise. Your safe is now locked.

**SETTING THE ALARM**

- On closing the door press the "0" button, the display will show "BELL ON". The alarm is now set and will activate if the safe is moved or attacked. The alarm will sound for 60 seconds. While the alarm is sounding if the correct code is entered the alarm will stop.

**SETTING THE USER CODE**

**OPTION A**

- Press the "#" button, enter the current user code (pre-set user code is 1234) followed by "\*", the display will show "OPEN". Within 5 seconds, press the "\*" button, the display will show ".....".
- Enter the new code (3-8 digits) and press "#" to confirm. The display will show "INTO", indicating the new code has been successfully set.

**OPTION B**

- With the door open press the reset button (2), the display shows "....."
- Enter the new code (3-8 digits) and press "#" to confirm. The display will show "INTO", indicating the new code has been successfully set.

**SETTING THE MASTER CODE**

**OPTION A**

- Press the "#" button and enter the current master code (pre-set master code is 123456) followed by "#", the display will show "OPEN". Within 5 seconds, press the "\*" button, the display will show ".....".
- Enter the new code (3-8 digits) and press "#" to confirm. The display will show "INTO", which indicates the new code has been successfully set.

**OPTION B**

- With the door open press the "#" button followed by the "0" button twice, then press reset button (2).
- Enter the new master code (3-8 digits), and press the "#" button to confirm, the display will show "INTO", indicating the new code has been successfully set.

**SETTING DATE AND TIME**

- On inserting the batteries the date and time will be shown as - 00-01-01 (year-month-day), and 00:00 (hour-minute).
- With the safe in standby mode, press the "\*" button and the backlight will illuminate. The 1st number will start flashing prompting the year to be entered, followed by the, month, day, hour and minute.
- Once the minute has been entered the backlight will turn off and the date and time has been set.

**CHECK THE OPENING RECORD**

- On opening the door, wait for "OPEN" to disappear from the display and within 2 seconds press "0".
  - The display will show the record of when the door was last opened. (Year, month, date, hour, minute and which code was used to open the safe)
- NOTE:** "PASS 1" means the door was opened by the user code. "PASS 2" means the door was opened by the master code.
- Press "0" before the "PASS 1 or 2" disappears from the display to show the previous opening record (the last 45 records can be viewed). Press "8" to scroll back to the most recent records.

**MOUNTING METHOD**

- Place the safe into the required position and mark the floor / wall through the holes in the back/base of the safe.
- Drill the holes for the expansion bolts using the marked positions.
- With the safe in position insert the fully assembled bolt through the back or base of the safe and into the drilled holes.
- Tighten the nuts until secure.

**CAUTION:** The expansion bolts supplied are only suitable for concrete floor or wall surfaces.

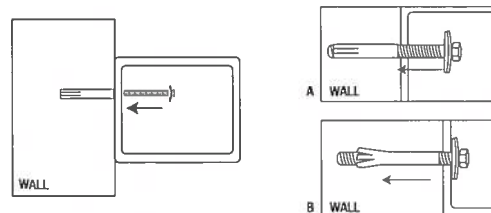

**SS0100E OPERATING INSTRUCTIONS  
& GUARANTEE REGISTRATION**

Please submit your guarantee registration by visiting our website [www.phoenixsafe.com](http://www.phoenixsafe.com) and clicking on guarantee registration.

For further assistance or information please contact us on 0151 944 6444.

APEX HOUSE, 1 ORRELL MOUNT, LIVERPOOL, L20 6NS,  
UNITED KINGDOM | +44 (0)151 944 6444